



MARRIOTT MARQUIS  
CHICAGO

EMPOWERING  
NEW PERCEPTIONS.

IN THE CITY OF BIG SHOULDERS.





## LEVEL 2

Meeting Room	DIMENSIONS			CAPACITY				
	Dimensions (L×W×H)	Area (Sq. Feet)	Theater	Schoolroom	Conference	U-Shape	Reception	Banquet
Shedd	39×61×10	1,940	157	64	32	36	150	110
Shedd A	39×30×10	1,070	92	32	16	16	75	50
Shedd B	27×31×10	870	83	32	16	18	75	50
Marina City	35×24×10	894	84	34	16	20	88	50
Water Tower	76×31×10	2,304	231	78	40	40	180	120
Water Tower A	41×31×10	1,255	109	42	20	22	90	80
Water Tower B	34×31×10	1,041	106	36	16	22	90	60
Great Lakes Ballroom	168×149×24	24,997	3,068	1,154	—	—	2,100	1,610
Great Lakes A	45×63×24	2,790	336	120	—	—	—	150
Great Lakes B	52×63×24	3,291	416	168	—	—	—	200
Great Lakes C	51×63×24	3,205	388	144	—	—	—	200
Great Lakes D	149×34×24	5,192	—	—	—	—	—	—
Great Lakes E	45×69×24	3,120	277	100	—	—	—	140
Great Lakes F	52×69×24	3,620	350	120	—	—	—	200
Great Lakes G	51×69×24	3,620	316	120	—	—	—	190
Great Lakes A/B	97×63×24	6,081	621	238	—	—	—	400
Great Lakes B/C	104×63×24	6,497	675	252	—	—	—	450
Great Lakes E/F	97×69×24	6,739	529	192	—	—	—	360
Great Lakes F/G	104×69×24	7,240	575	216	—	—	—	370
Great Lakes A/B/C	168×63×24	9,286	1,064	392	—	—	—	600
Great Lakes E/F/G	168×69×24	10,360	920	336	—	—	—	540
Great Lakes A/B/C/D	168×98×24	14,478	1,728	714	—	—	—	960
Great Lakes D/E/F/G	168×104×24	15,551	1,485	616	—	—	—	910
Great Lakes Foyer	—	7,897	—	—	—	—	—	—
Algebra Board Room	26×18×9	474	—	—	10	—	—	—
Analysis	37×23×9	837	81	24	16	20	75	50
Anthropology	33×19×9	615	56	20	16	16	45	30
Architecture	38×23×9	885	81	24	16	20	75	50
Astronomy	33×18×9	612	56	20	16	14	45	30
Biology	29×23×9	640	54	16	12	14	45	30
Calculus	37×23×9	832	81	24	16	20	75	50
Chemistry Board Room	26×18×9	474	—	—	10	—	—	—
Culture	23×37×9	837	81	24	16	20	75	50
Dance	33×19×9	615	56	20	16	16	45	30
Geography	23×36×9	845	81	24	16	20	75	50
Geology	33×18×9	612	54	16	12	14	45	30
Integrals	21×29×9	640	56	20	16	14	45	30
History	23×37×9	729	81	24	16	20	75	50
Literature	21×31×9	729	70	20	16	16	75	40
Journalism	23×38×9	838	81	24	16	20	75	50
Philosophy	40×18×9	716	64	24	20	18	60	40
Music Board Room	23×18×9	400	—	—	10	—	—	—

## LEVEL 2

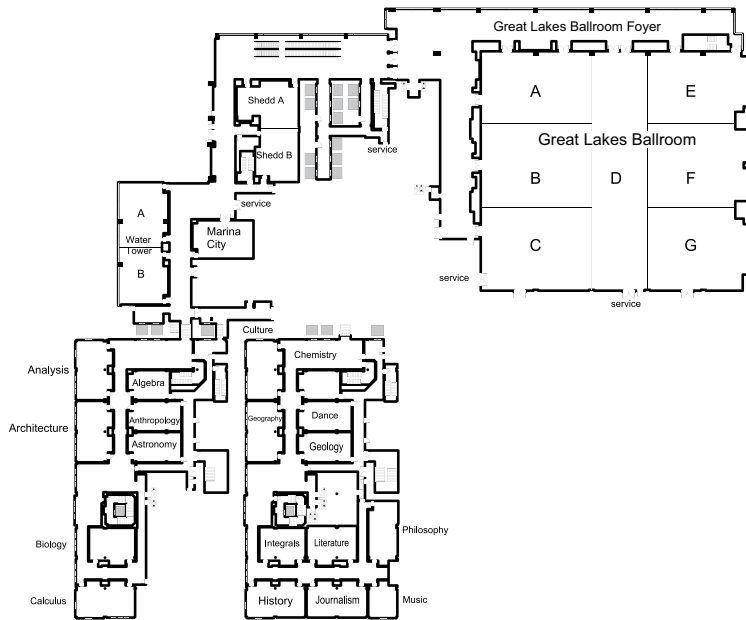

## LEVEL 3

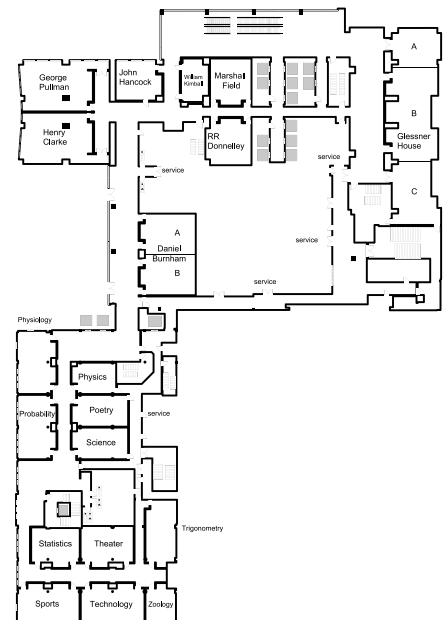

## LEVEL 3

### DIMENSIONS

### CAPACITY

Meeting Room	DIMENSIONS		CAPACITY					
	Dimensions (L×W×H)	Area (Sq. Feet)	Theater	Schoolroom	Conference	U-Shape	Reception	Banquet
Glessner House	117×29×10	3,285	284	116	68	70	180	200
Glessner House A	23×29×10	649	58	24	12	12	60	40
Glessner House B	58×29×10	1,549	126	44	32	30	90	90
Glessner House C	40×29×10	1,195	88	36	20	20	75	60
Glessner House A/B	140×29×10	2,198	179	78	44	42	150	120
Glessner House B/C	99×29×10	2,744	216	86	52	48	165	140
RR Donnelley	28×24×10	662	55	24	12	12	60	40
Marshall Field	27×27×10	714	60	24	12	12	60	40
William Kimball Board Room	26×16×10	348	—	—	10	—	—	—
John Hancock	27×24×10	635	48	20	12	12	60	40
George Pullman	43×31×10	1,364	86	40	20	18	120	70
Henry Clarke	43×31×10	1,355	86	40	20	18	120	70
Daniel Burnham	49×33×10	1,563	182	60	24	28	150	100
Daniel Burnham A	25×33×10	820	70	30	16	16	75	50
Daniel Burnham B	23×33×10	734	70	30	16	16	75	50
Physics Board Room	26×18×9	473	—	—	10	—	—	—
Physiology	37×23×9	836	81	24	16	20	75	50
Poetry	33×19×9	615	56	20	16	16	45	30
Probability	38×23×9	846	81	24	16	20	75	50
Science	33×18×9	612	56	20	16	14	45	30
Statistics	29×21×9	640	54	16	12	14	45	30
Sports	37×23×9	831	81	24	16	20	75	50
Theater	31×25×9	729	70	20	16	16	75	40
Technology	38×23×9	838	81	24	16	20	75	50
Trigonometry	38×18×9	715	64	24	20	18	60	40
Zoology Board Room	23×18×9	401	—	—	10	—	—	—

## LEVEL 4

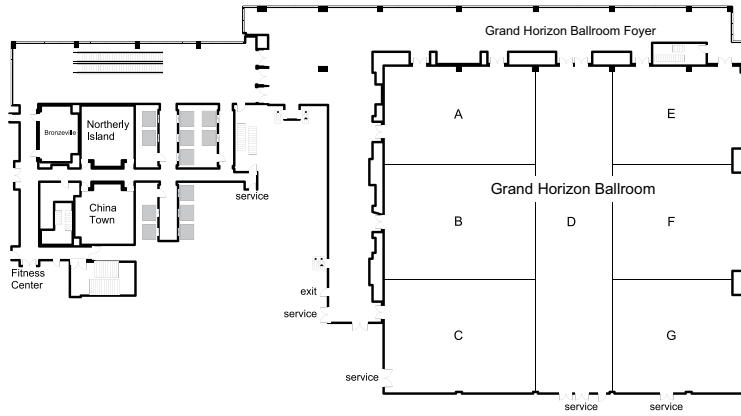

## LEVEL 4

### DIMENSIONS

### CAPACITY

Meeting Room	Dimensions (L×W×H)	Area (Sq. Feet)	Theater	Schoolroom	Conference	U-Shape	Reception	Banquet
Grand Horizon Ballroom	168×149×29	24,963	3,068	1,154	—	—	2,100	1,610
Grand Horizon A	45×63×29	2,788	336	120	—	—	—	150
Grand Horizon B	52×63×29	3,221	416	168	—	—	—	200
Grand Horizon C	52×63×29	3,221	388	144	—	—	—	200
Grand Horizon D	149×34×29	5,191	—	—	—	—	—	—
Grand Horizon E	45×69×29	3,124	277	100	—	—	—	140
Grand Horizon F	52×69×29	3,621	350	120	—	—	—	200
Grand Horizon G	52×69×29	3,626	316	120	—	—	—	190
Grand Horizon A/B	97×63×29	6,009	316	120	—	—	—	400
Grand Horizon B/C	104×63×29	6,442	621	238	—	—	—	450
Grand Horizon E/F	97×69×29	6,745	675	252	—	—	—	360
Grand Horizon F/G	104×69×29	7,247	529	192	—	—	—	370
Grand Horizon A/B/C	168×63×29	9,230	575	216	—	—	—	600
Grand Horizon E/F/G	168×69×29	10,371	1,064	392	—	—	—	540
Grand Horizon A/B/C/D	168×98×29	14,421	920	336	—	—	—	960
Grand Horizon D/E/F/G	168×104×29	15,562	1,728	714	—	—	—	910
Grand Horizon Foyer	—	8,095	—	—	—	—	—	—
Northerly Island	28×24×10	662	60	24	12	12	—	40
Bronzeville Board Room	26×16×10	393	—	—	10	—	—	—
China Town	27×24×10	701	60	24	12	12	—	40

## ACCOMMODATIONS

40 floors • 1,161 rooms • 44 suites • 62 meeting rooms

## RESTAURANTS & LOUNGES

Showroom Food Hall, a vibrant food hall inspired by Chicago's motor row featuring five culinary concepts showcasing all-American comfort cuisine • Woven + Bound offers delicious American Brasserie Cuisine inspired by the diverse culture of Chicago for breakfast, lunch and dinner • 2121 Pantry features freshly prepared sandwiches, salads and quick bites 24/7 • M Club Lounge provides flexible spaces to work, connect and recharge with 24-hour accessibility

## RECREATION & LEISURE

State-of-the-art fitness center

## ATTRACTIONS

Shedd Aquarium • Museum Campus • Millennium Park • New Maggie Daley Park • Northerly Island • Soldier Field • U.S. Cellular Field • Wrigley Field • Navy Pier • Art Institute of Chicago • Lincoln Park Zoo • Adler Planetarium • Field Museum • Grant Park • Glessner House Museum • Clarke House Museum

## GUEST SERVICES

Business Center • Daily newspaper delivery • 24 hour room service • Copy/fax service • Valet parking

## MEETINGS

Over 93,000 square feet of total meeting space • Both the Grand Horizon Ballroom and Great Lakes Ballroom offer over 25,000 square feet of space and can accommodate up to 2,100 people • 48 breakout rooms

## LOCATION

Conveniently located in Chicago's revitalized South Loop area, the center for the city's latest modern developments and a hub for business and events

### MARRIOTT MARQUIS CHICAGO

2121 SOUTH PRAIRIE AVENUE CHICAGO, IL 60616  
312.824.0500 MARRIOTTMARQUISCHICAGO.COM

f/MarquisChi @Marquis\_Chicago @Marquis\_Chicago

© 2018 Marriott International, Inc.

