

HOTEL MEETING SPACE

First, Second, & Third floor

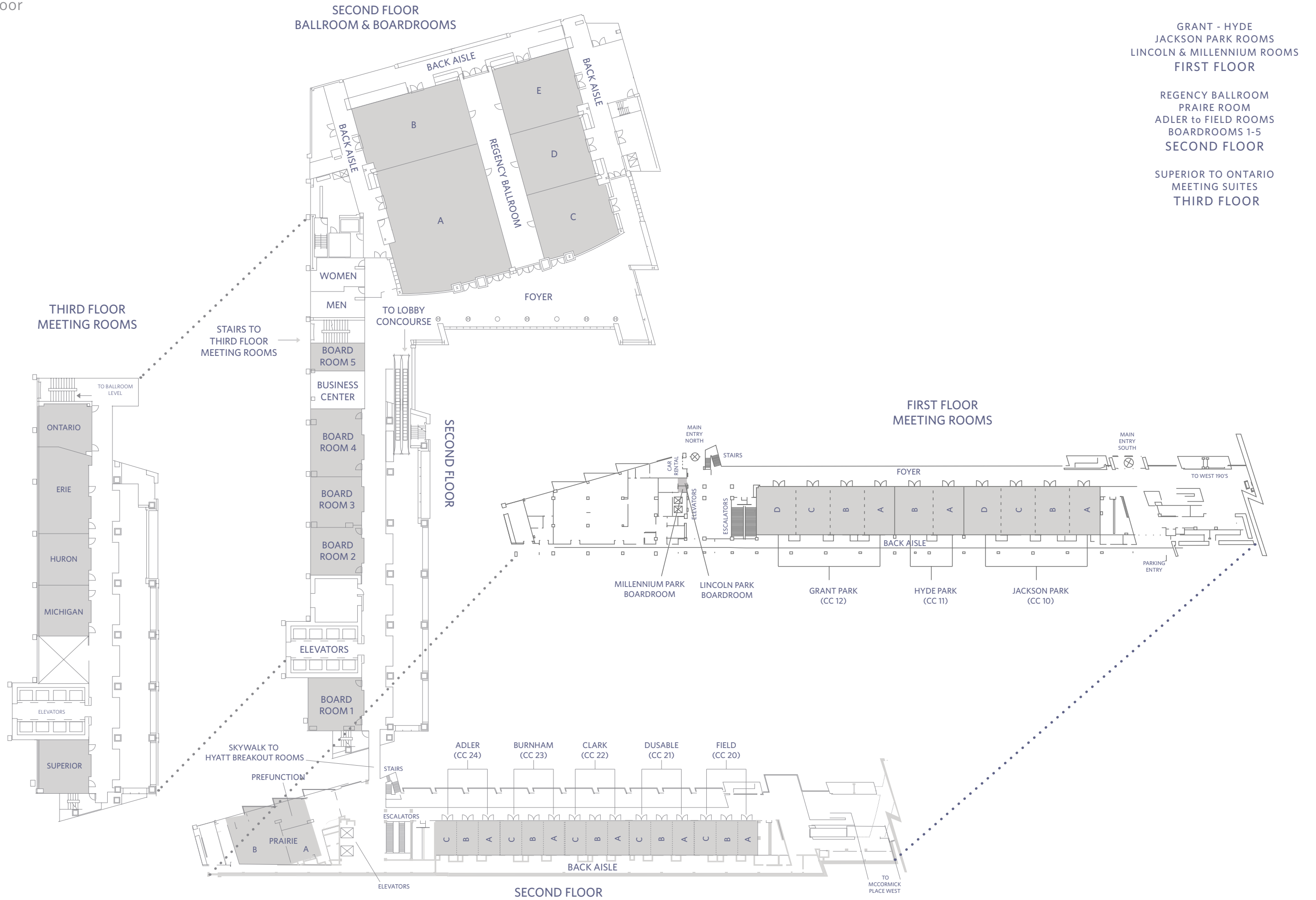

HOTEL MEETING SPACE

South 100 Level Meeting Rooms & West 190 Level Meeting Space

MCCORMICK PLACE SOUTH 100 BUILDING MEETING ROOMS

HOTEL
SOUTH 100
BUILDING
WEST 190

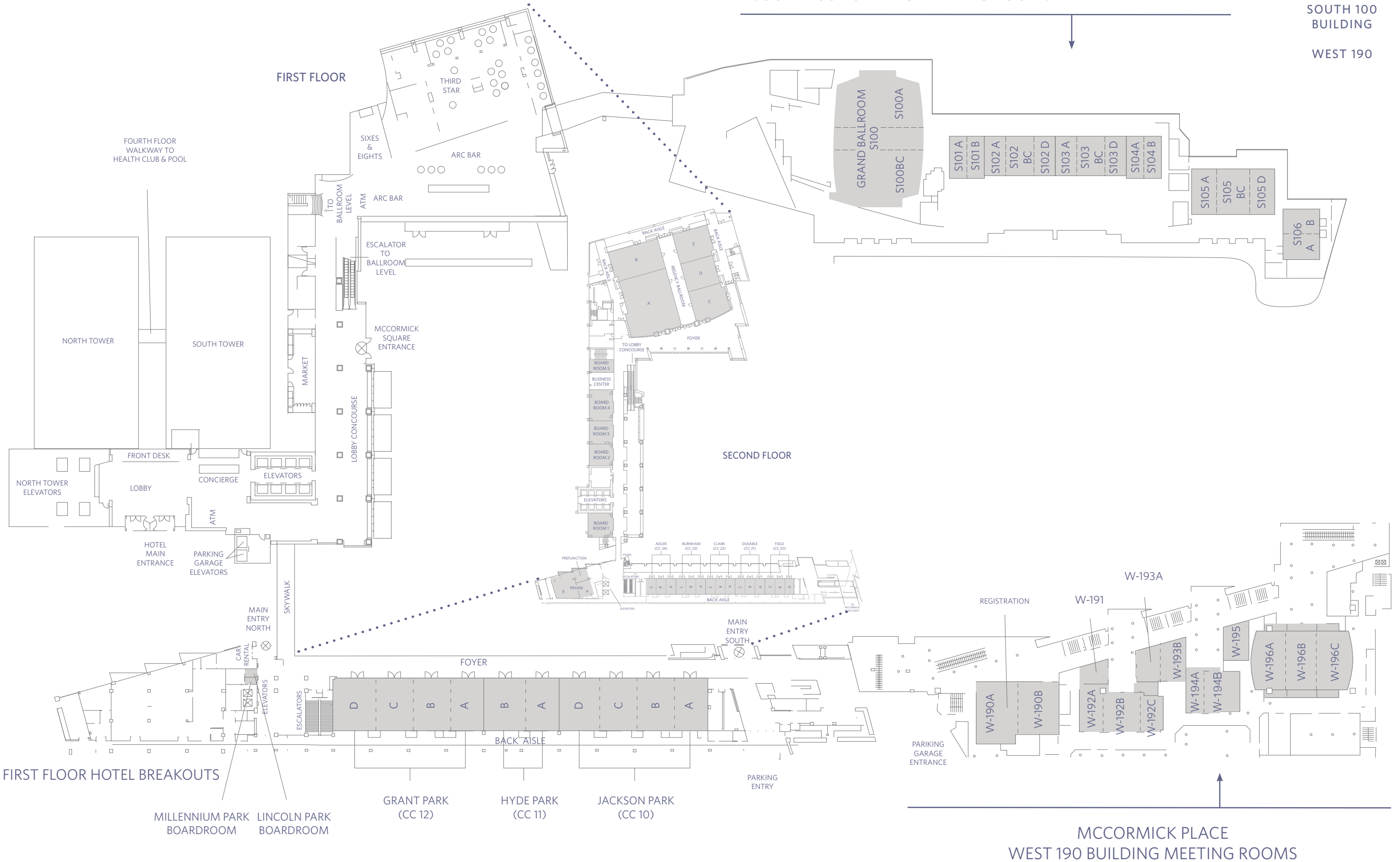

MCCORMICK PLACE WEST 190 BUILDING MEETING ROOMS

WEST BUILDING - LEVEL 3
W-375 SKYLINE BALLROOM

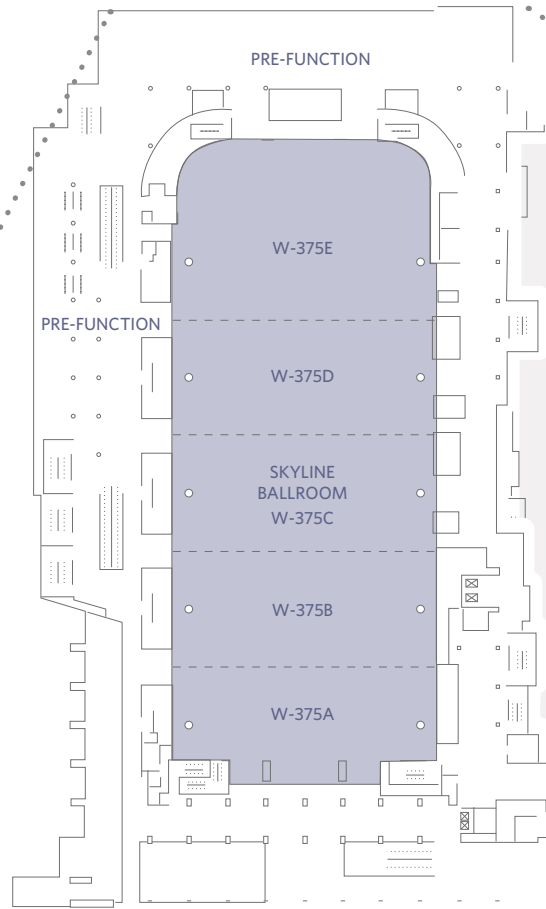

WEST BUILDING - LEVEL 5
OUTDOOR TERRACE

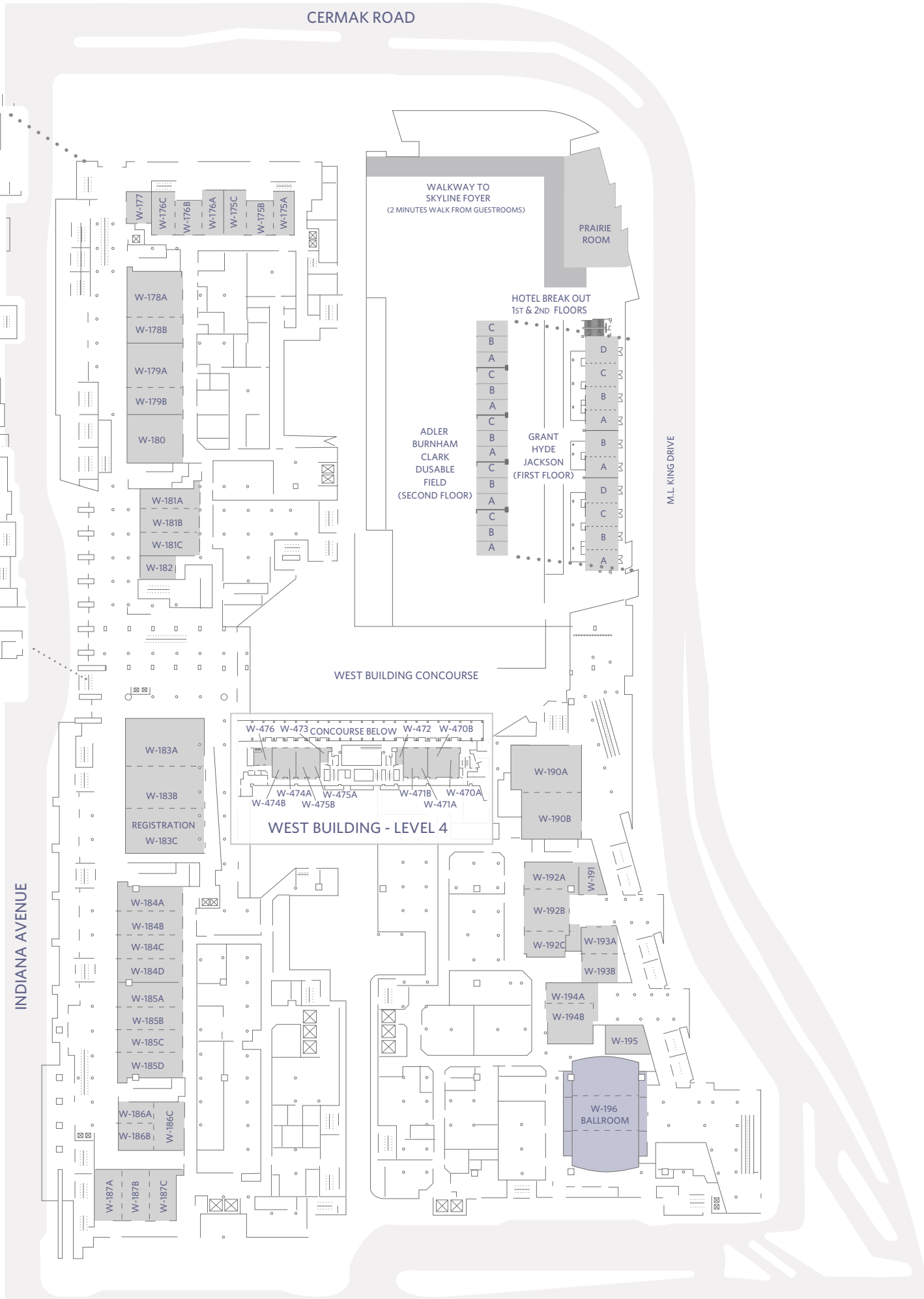
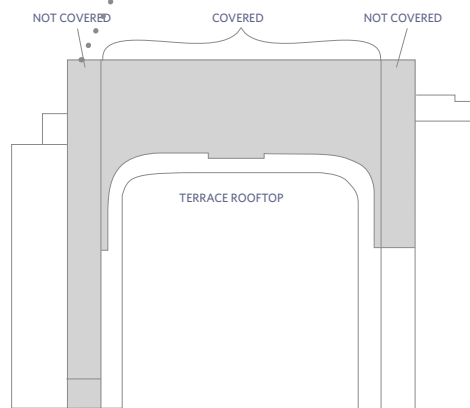

HOTEL MEETING SPACE

South 100, 400, 500 Meeting Rooms & North 400 Meeting Room Level

SOUTH BUILDING

SOUTH BUILDING LEVEL 1

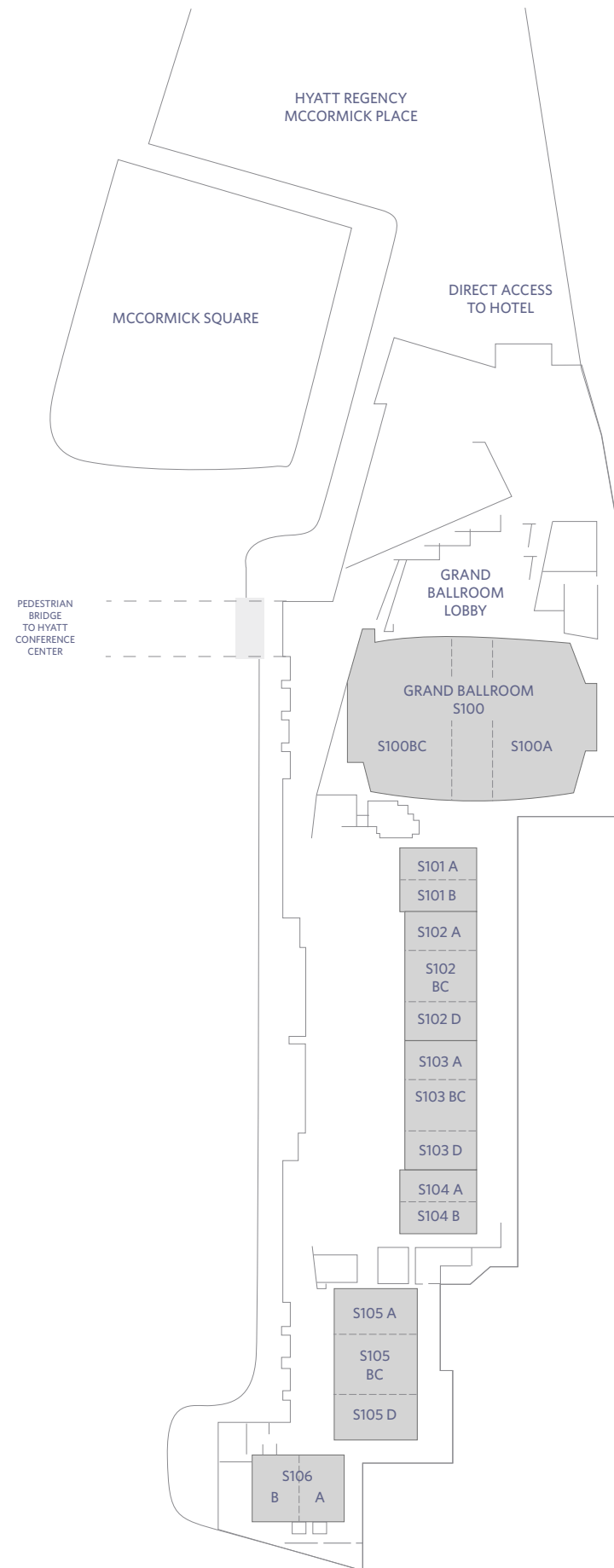

SOUTH BUILDING LEVEL 5

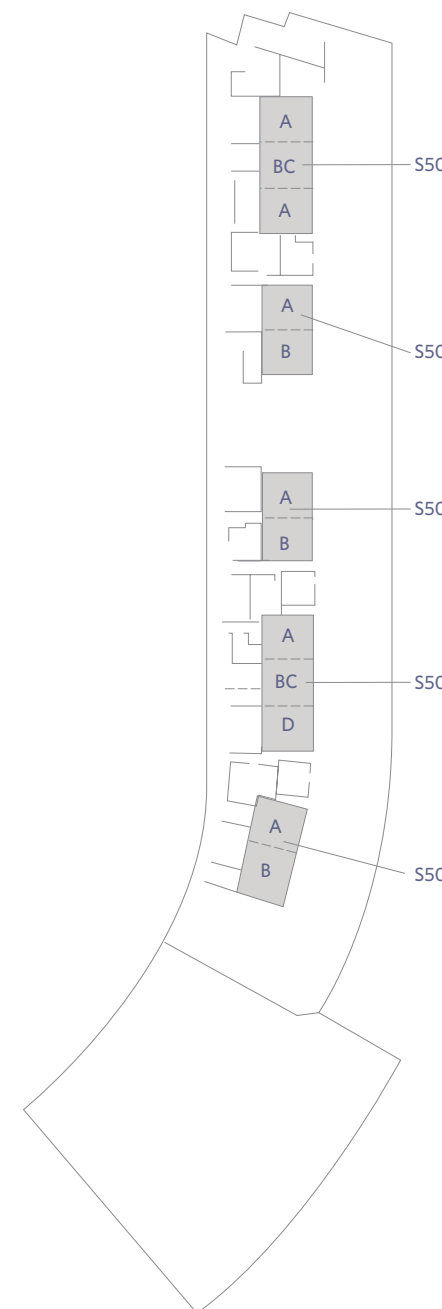

NORTH BUILDING LEVEL 4

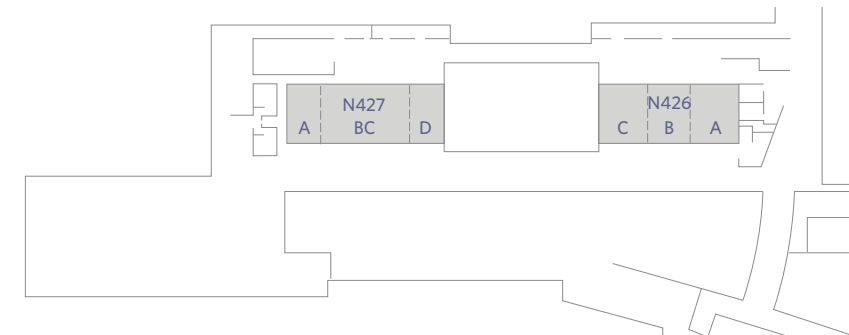

SOUTH BUILDING LEVEL 4

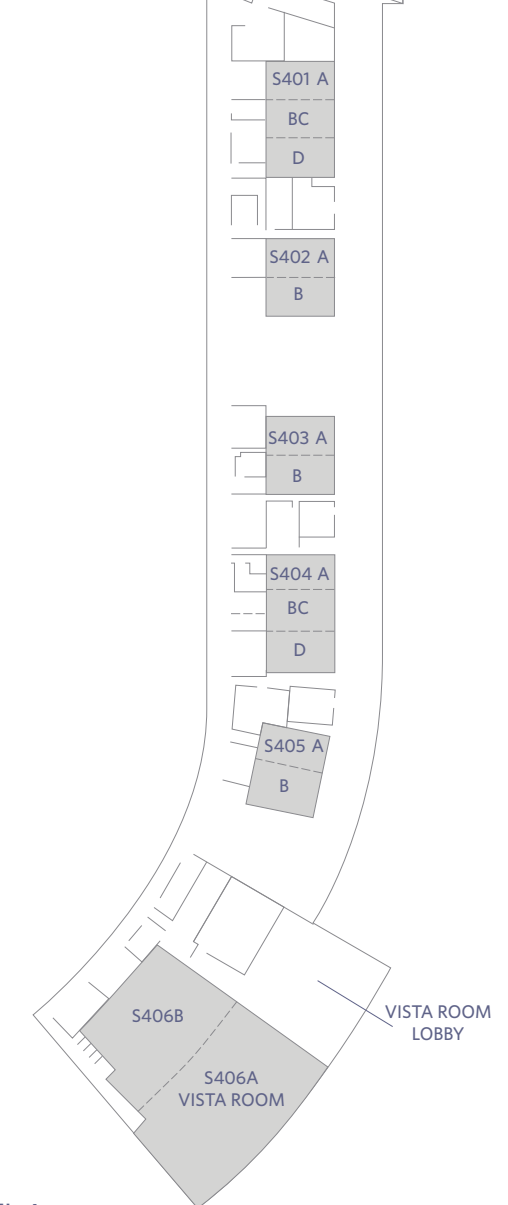

HOTEL MEETING SPACE

Lakeside Building Meeting Rooms; Including Arie Crown Theater

LAKESIDE BUILDING

LAKESIDE CENTER LEVEL 2

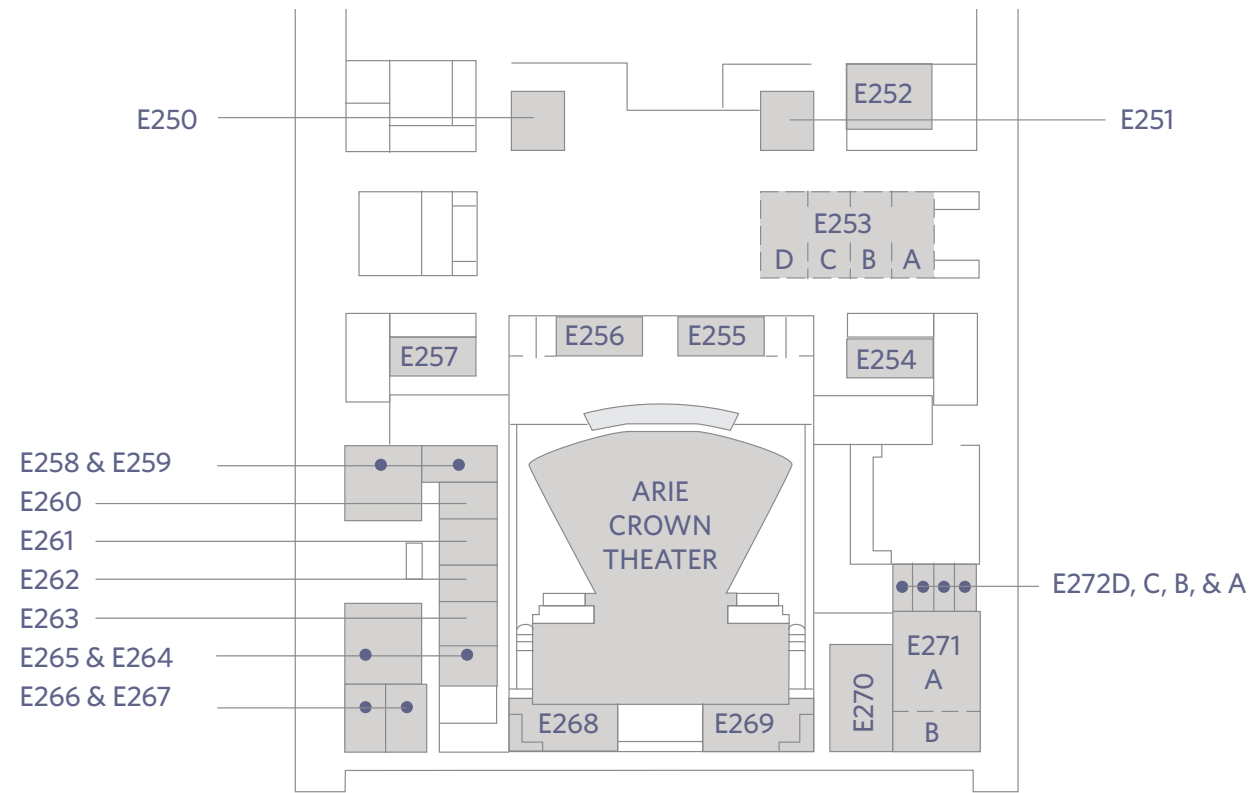

LAKESIDE CENTER LEVEL 3

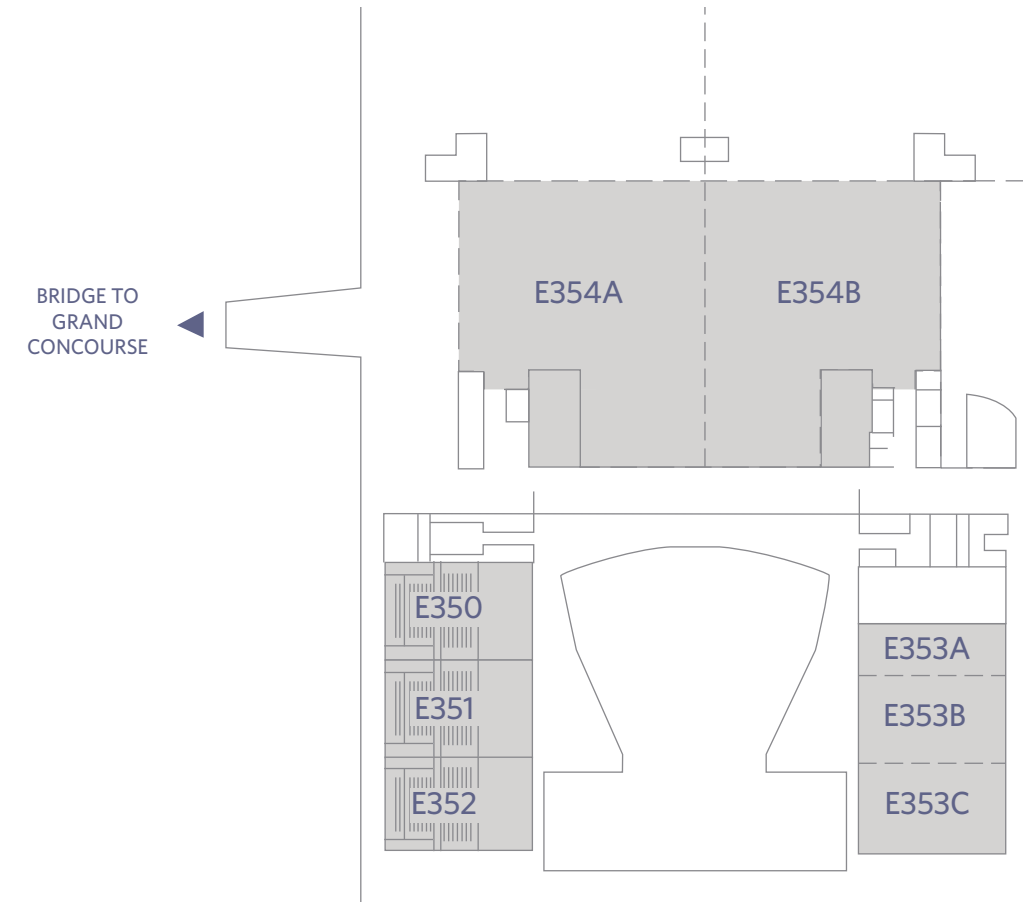

LAKESIDE CENTER LEVEL 4

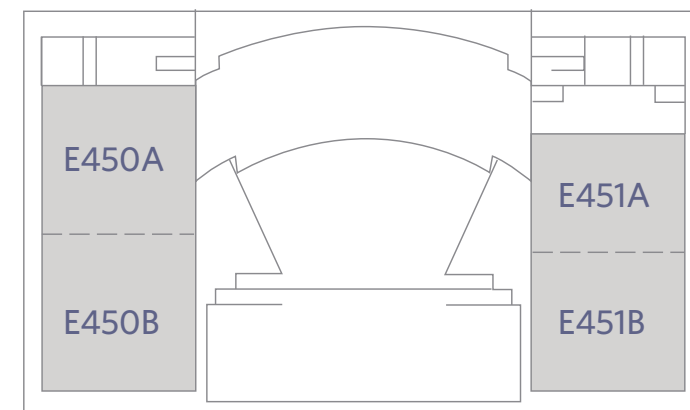

HOTEL MEETING SPACE

South Building 400, 500 Level Meeting Rooms & Lakeside Meeting Rooms; Including Arie Crown Theater

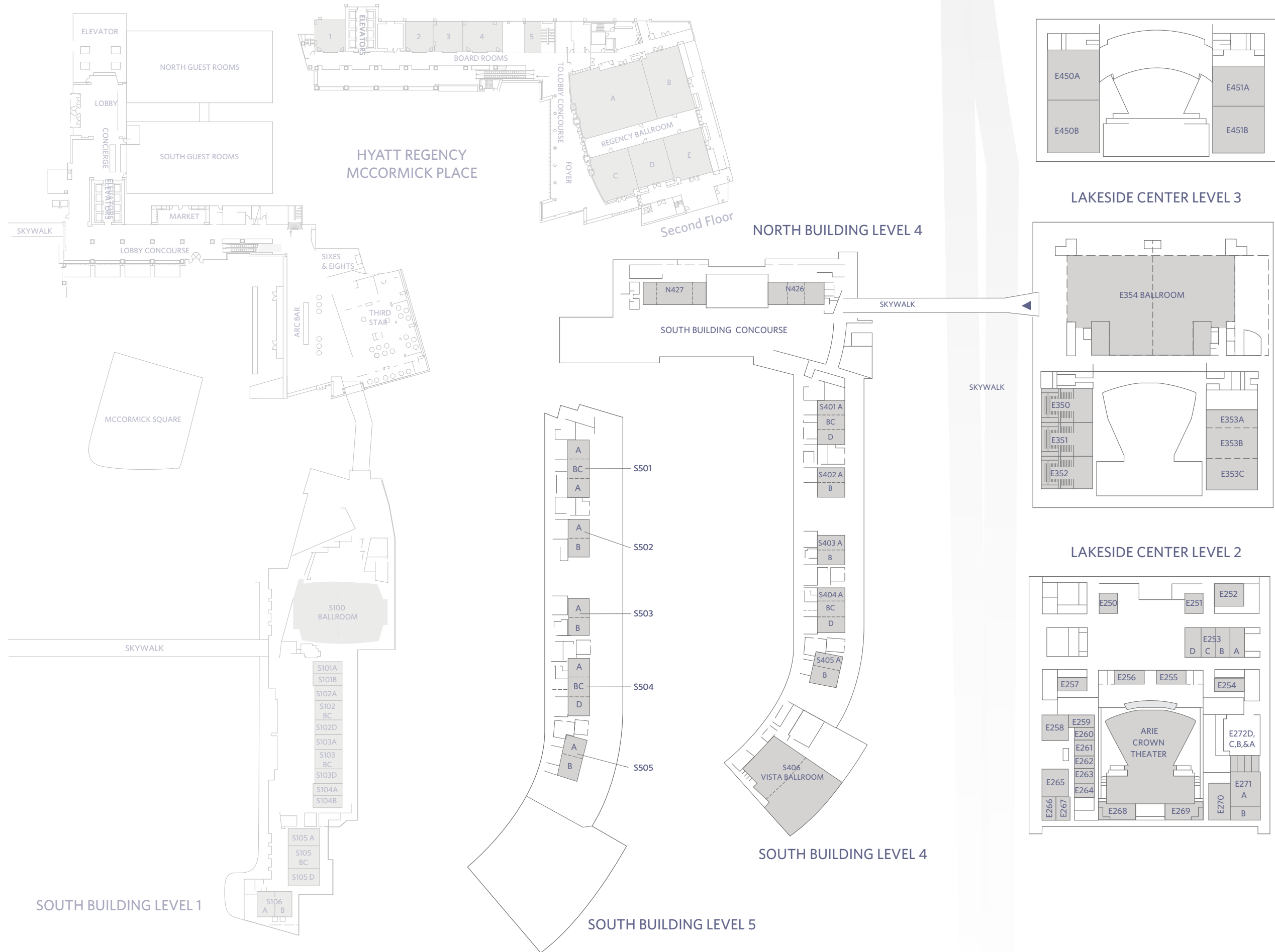

HOTEL
SOUTH BUILDING
LAKESIDE BUILDING

NORTH BUILDING LEVEL 1

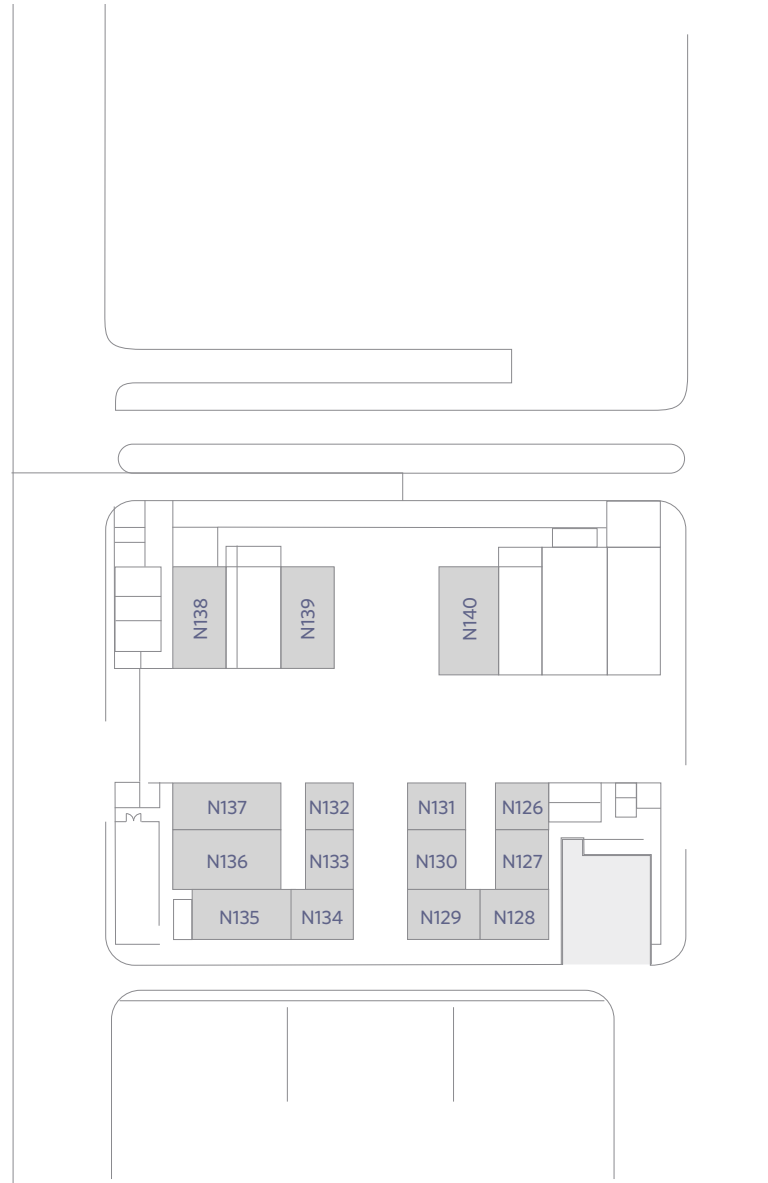

NORTH BUILDING LEVEL 2

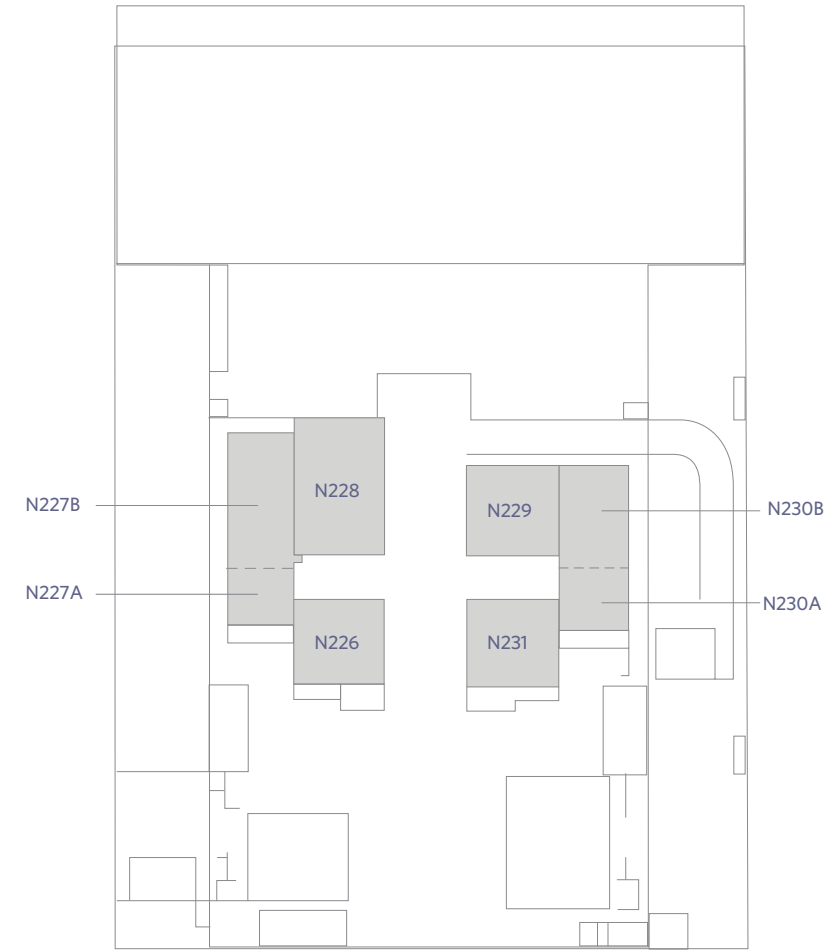

NORTH BUILDING LEVEL 4

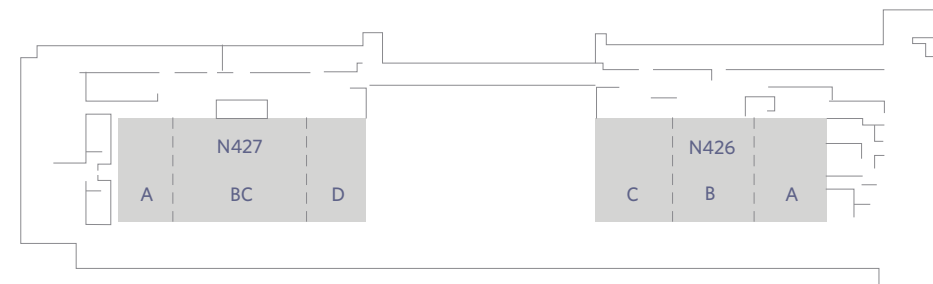

CAPACITY CHART



Room Name	Room Dimensions L x W x H	Room Size Sq. Ft.	Banquet	Reception	Theater	Classroom	Boardroom	U-Shape	Hollow Square	Exhibit
-----------	------------------------------	----------------------	---------	-----------	---------	-----------	-----------	---------	------------------	---------

West Bulding Level One

W-175	—	4,396	230	—	440	213	—	—	—	—
W-175A	31'6" x 56'3" x 20'	1,642	90	—	173	84	—	—	—	—
W-175B	26' x 44' x 20'	1,106	50	—	101	48	—	—	—	—
W-175C	32'7" x 56'3" x 20'	1,648	90	—	166	81	—	—	—	—
W-176	—	4,409	230	—	438	213	—	—	—	—
W-176A	32'2" x 56'3" x 20'	1,658	90	—	167	81	—	—	—	—
W-176B	26'2" x 44' x 20'	1,112	50	—	100	48	—	—	—	—
W-176C	31'5" x 56'3" x 20'	1,639	90	—	171	84	—	—	—	—
W-177	27'4" x 30' x 16'2"	784	40	—	71	36	—	—	—	—
W-178	84' x 64'4" x 20'	5,433	280	—	504	252	—	—	—	—
W-178A	54' x 64'4" x 20'	3,501	180	—	324	162	—	—	—	—
W-178B	30' x 64'4" x 20'	1,932	100	—	180	90	—	—	—	—
W-179	84' x 64'4" x 20'	5,433	280	—	504	252	—	—	—	—
W-179A	54' x 64'4" x 20'	3,501	180	—	324	162	—	—	—	—
W-179B	30' x 64'4" x 20'	1,932	100	—	180	90	—	—	—	—
W-180	55'4" x 67'10" x 20'	3,582	180	—	337	168	—	—	—	—
W-181	83'4" x 74'6" x 20'	6,031	300	—	554	273	—	—	—	—
W-181A	28'2" x 76'6" x 20'	2,091	100	—	189	93	—	—	—	—
W-181B	27' x 74'6" x 20'	1,931	100	—	179	87	—	—	—	—
W-181C	28'2" x 76'6" x 20'	2,009	100	—	186	93	—	—	—	—
W-182	25'6" x 37'2" x 16'2"	1,058	50	—	92	45	—	—	—	—
W-183	163' x 78' x 26'1"	13,612	700	—	1,272	630	—	—	—	—
W-183A	58'8" x 78' x 26'1"	4,755	250	—	452	225	—	—	—	—
W-183B	56' x 78' x 26'1"	4,662	240	—	431	213	—	—	—	—
W-183C	50' x 78' x 26'1"	4,195	210	—	389	192	—	—	—	—
W-184	118' x 79'6" x 20'1"	8,864	460	—	843	414	—	—	—	—
W-184A	30'11" x 79'6" x 20'1"	2,292	120	—	221	108	—	—	—	—
W-184BC	56' x 79'6" x 20'1"	4,280	220	—	400	198	—	—	—	—
W-184D	31' x 79'6" x 20'1"	2,292	120	—	222	108	—	—	—	—
W-185	118' x 79'6" x 20'1"	8,864	460	—	838	414	—	—	—	—
W-185A	30'11" x 79'6" x 20'1"	2,292	120	—	220	108	—	—	—	—
W-185BC	56' x 79'6" x 20'1"	4,280	220	—	397	198	—	—	—	—
W-185D	31' x 79'6" x 20'1"	2,292	120	—	221	108	—	—	—	—
W-186	73'1" x 51'8" x 19'10"	4,067	200	—	374	186	—	—	—	—
W-186A	25'11" x 37'1" x 19'10"	1,012	50	—	94	48	—	—	—	—
W-186B	29'5" x 37'1" x 19'10"	1,063	50	—	94	48	—	—	—	—
W-186C	36' x 51'8" x 19'10"	1,992	100	—	186	90	—	—	—	—

CAPACITY CHART



Room Name	Room Dimensions L x W x H	Room Size Sq. Ft.	Banquet	Reception	Theater	Classroom	Boardroom	U-Shape	Hollow Square	Exhibit
-----------	------------------------------	----------------------	---------	-----------	---------	-----------	-----------	---------	------------------	---------

West Building— Level West Bulding Level One (Cont.)

W-187	102'7" x 53' x 20'1"	5,791	280	—	540	267	—	—	—	—
W-187A	33'1" x 53' x 20'1"	1,871	90	—	175	87	—	—	—	—
W-187B	36' x 53' x 20'1"	2,206	100	—	189	93	—	—	—	—
W-187C	33'6" x 53' x 20'1"	1,893	90	—	176	87	—	—	—	—
W-190	—	9,378	520	—	948	474	—	—	—	—
W-190A	58'5" x 97'1" x 25'10"	5,239	290	—	522	261	—	—	—	—
W-190B	58'2" x 74'1" x 25'10"	4,139	230	—	426	213	—	—	—	—
W-191	36'1" x 26'6" x 16'2"	908	50	—	93	45	—	—	—	—
W-192C	31'4" x 66'4" x 20'1"	2,014	110	—	210	102	—	—	—	—
W-193	68'11" x 48'6" x 20'1"	3,013	140	—	268	129	—	—	—	—
W-193A	33'8" x 48'6" x 20'1"	1,532	70	—	137	66	—	—	—	—
W-193B	31'2" x 48'6" x 20'1"	1,481	70	—	131	63	—	—	—	—
W-194	55' x 72'7" x 20'	4,236	220	—	407	201	—	—	—	—
W-194A	24'9" x 55' x 20'	1,482	70	—	135	66	—	—	—	—
W-194B	47'10" x 55' x 20'	2,754	150	—	272	135	—	—	—	—
W-195	34'4" x 52'1" x 19'1"	1,712	80	—	153	75	—	—	—	—
W-196	146'8" x 106'5" x 24'10"	14,342	720	—	1,321	654	—	—	—	—
W-196A	51'3" x 106'5" x 24'10"	4,800	230	—	424	210	—	—	—	—
W-196B	44' x 106'5" x 24'10"	4,743	260	—	473	234	—	—	—	—
W-196C	51'3" x 106'5" x 24'10"	4,799	230	—	424	210	—	—	—	—

West Building— Level Three Ballroom

W-375	481' x 208'8" x VARIES	103,760	5,550	—	10,000	5,001	—	—	—	—
W-375A	72'9" x 208'8" x VARIES	16,859	930	—	1,680	840	—	—	—	—
W-375B	89'8" x 208'8" x VARIES	19,122	980	—	1,768	844	—	—	—	—
W-375C	90' x 208'8" x 39'10"	19,197	980	—	1,768	844	—	—	—	—
W-375D	90' x 208'8" x 39'10"	19,197	980	—	1,768	844	—	—	—	—
W-375E	138'6" x 197'3" x VARIES	29,387	1,680	—	3,016	1,508	—	—	—	—

West Building— Level Four

W-470	84' x 70'6" x 17'2"	6,250	320	—	587	291	—	—	—	—
W-470A	42' x 70'6" x 17'2"	3,123	160	—	292	144	—	—	—	—
W-470B	42' x 70'6" x 17'2"	3,127	160	—	295	147	—	—	—	—
W-471	62'2" x 70'6" x 17'	4,724	240	—	434	216	—	—	—	—
W-471A	31'2" x 70'6" x 17'	2,368	120	—	217	108	—	—	—	—
W-471B	31' x 70'6" x 17'	2,356	120	—	217	108	—	—	—	—
W-472	20'10" x 41' x 16'3"	797	30	—	62	30	—	—	—	—
W-473	21'2" x 41' x 16'4"	809	40	—	75	36	—	—	—	—
W-474	62'2" x 70'6" x 16'11"	4,724	240	—	434	216	—	—	—	—
W-474A	31' x 70'6" x 16'11"	2,356	120	—	219	108	—	—	—	—
W-474B	31'2" x 70'6" x 16'11"	2,368	120	—	215	108	—	—	—	—
W-475	62' x 70'6" x 17'	4,712	240	—	433	216	—	—	—	—
W-475A	31'1" x 70'6" x 17'	2,165	120	—	216	108	—	—	—	—
W-475B	30'11" x 70'6" x 17'	2,177	120	—	217	108	—	—	—	—
W-476	50'2" x 36'4" x 17'	2,011	100	—	182	90	—	—	—	—

CAPACITY CHART



Room Name	Room Dimensions L x W x H	Room Size Sq. Ft.	Banquet	Reception	Theater	Classroom	Boardroom	U-Shape	Hollow Square	Exhibit
-----------	------------------------------	----------------------	---------	-----------	---------	-----------	-----------	---------	------------------	---------

Convention Center South Building — Level One

S100	151' x 214'2" x 23'	33,740	1,800	—	2,998	1,499	—	—	—	—
S100A	151' x 111' x 23'	16,760	894	—	1,489	745	—	—	—	—
S100BC	151' x 112'5" x 23'	16,980	906	—	1,508	754	—	—	—	—
S101	57' x 74' x 20'	4,273	228	—	350	190	—	—	—	—
S101A	28'11" x 74' x 20'	2,142	114	—	190	95	—	—	—	—
S101B	28'9" x 74' x 20'	2,131	114	—	190	95	—	—	—	—
S102	114' x 70' x 20'	8,224	439	—	730	364	—	—	—	—
S102A	33' x 70' x 20'	2,347	126	—	210	105	—	—	—	—
S102BC	48' x 70' x 20'	3,515	186	—	310	154	—	—	—	—
S102D	33' x 70' x 20'	2,362	126	—	210	105	—	—	—	—
S103	114' x 70' x 20'	8,211	438	—	730	364	—	—	—	—
S103A	33' x 70' x 20'	2,347	126	—	210	105	—	—	—	—
S103BC	48' x 70' x 20'	3,515	186	—	310	154	—	—	—	—
S103D	33' x 70' x 20'	2,362	126	—	210	105	—	—	—	—
S104	57' x 74' x 20'	4,276	228	—	380	190	—	—	—	—
S104A	28' x 74' x 20'	2,138	114	—	190	95	—	—	—	—
S104B	28' x 74' x 20'	2,139	114	—	190	95	—	—	—	—
S105	136' x 76' x 20'	10,358	570	—	952	475	—	—	—	—
S105A	47' x 76' x 20'	3,591	191	—	319	159	—	—	—	—
S105BC	45' x 76' x 20'	3,532	188	—	319	157	—	—	—	—
S105D	47' x 76' x 20'	3,591	191	—	319	159	—	—	—	—
S106	86' x 61' x 20'	5,448	290	—	484	242	—	—	—	—
S106A	43' x 61' x 20'	2,724	145	—	242	121	—	—	—	—
S106B	43' x 61' x 20'	2,724	145	—	242	121	—	—	—	—

Convention Center South Building — Level Four

S401	107' x 62' x 17'6"	6,657	357	—	596	257	—	—	—	—
S401A	35' x 62' x 17'6"	2,174	117	—	194	97	—	—	—	—
S401BC	37' x 62' x 17'6"	2,305	123	—	206	103	—	—	—	—
S401D	35' x 62' x 17'6"	2,177	117	—	194	97	—	—	—	—
S402	70' x 62' x 17'6"	4,360	232	—	346	192	—	—	—	—
S402A	35' x 62' x 17'6"	2,193	116	—	193	96	—	—	—	—
S402B	35' x 62' x 17'6"	2,167	116	—	193	96	—	—	—	—
S403	70' x 62' x 17'6"	4,339	232	—	388	194	—	—	—	—
S403A	35' x 62' x 17'6"	2,169	116	—	194	97	—	—	—	—
S403B	35' x 62' x 17'6"	2,170	116	—	194	97	—	—	—	—
S404	105' x 62' x 17'6"	6,553	352	—	588	294	—	—	—	—
S404A	33' x 62' x 17'6"	2,102	113	—	188	94	—	—	—	—
S404BC	37' x 62' x 17'6"	2,297	123	—	206	103	—	—	—	—
S404D	34' x 62' x 17'6"	2,154	116	—	194	97	—	—	—	—
S405	71' x 62' x 17'6"	4,432	236	—	394	196	—	—	—	—
S405A	35' x 62' x 17'6"	2,216	118	—	197	98	—	—	—	—
S405B	35' x 62' x 17'6"	2,216	118	—	197	98	—	—	—	—
S406	192' x 111' x 34'8"	21,365	1,139	—	1,898	948	—	—	—	—
S406A	158' x 82' x 34'8"	13,018	694	—	1,156	578	—	—	—	—
S406B	120' x 69' x 34'8"	8,347	445	—	742	370	—	—	—	—

CAPACITY CHART



Room Name	Room Dimensions L x W x H	Room Size Sq. Ft.	Banquet	Reception	Theater	Classroom	Boardroom	U-Shape	Hollow Square	Exhibit
-----------	------------------------------	----------------------	---------	-----------	---------	-----------	-----------	---------	------------------	---------

Convention Center South Building — Level Five

S501	108' x 45' x 17'6"	4,870	262	—	458	218	—	—	—	—
S501A	35' x 45' x 17'6"	1,589	85	—	142	70	—	—	—	—
S501BC	37' x 45' x 17'6"	1,693	92	—	154	78	—	—	—	—
S501D	35' x 45' x 17'6"	1,588	85	—	142	70	—	—	—	—
S502	70' x 45' x 17'6"	3,180	168	—	282	140	—	—	—	—
S502A	35' x 45' x 17'6"	1,593	84	—	141	70	—	—	—	—
S502B	35' x 45' x 17'6"	1,587	84	—	141	70	—	—	—	—
S503	70' x 45' x 17'6"	3,189	170	—	284	142	—	—	—	—
S503A	35' x 45' x 17'6"	1,596	85	—	142	71	—	—	—	—
S503B	35' x 45' x 17'6"	1,593	85	—	142	71	—	—	—	—
S504	107' x 45' x 17'6"	4,834	257	—	438	214	—	—	—	—
S504A	34' x 45' x 17'6"	1,549	82	—	138	69	—	—	—	—
S504BC	37' x 45' x 17'6"	1,688	90	—	151	75	—	—	—	—
S504D	35' x 45' x 17'6"	1,597	85	—	141	70	—	—	—	—
S505	71' x 45' x 17'6"	3,204	172	—	286	142	—	—	—	—
S505A	35' x 45' x 17'6"	1,604	86	—	143	71	—	—	—	—
S505B	35' x 45' x 17'6"	1,600	86	—	143	71	—	—	—	—

Convention Center North Building— Level One

N126	28'5" x 28'3" x 11'11"	802	32	—	70	36	—	—	—	—
N127	28'5" x 29'11" x 11'10"	842	40	—	74	42	—	—	—	—
N128	36'11" x 28'5" x 11'11"	1,043	48	—	95	51	—	—	—	—
N129	35'9" x 28'4" x 11'11"	1,014	40	—	85	44	—	—	—	—
N130	28'6" x 29'11" x 11'11"	853	40	—	77	39	—	—	—	—
N131	28'4" x 28'4" x 11'11"	803	40	—	64	36	—	—	—	—
N132	28'6" x 28'4" x 11'11"	807	40	—	64	36	—	—	—	—
N133	28'6" x 30' x 11'11"	855	40	—	77	39	—	—	—	—
N134	35'7" x 28'3" x 11'11"	1,005	40	—	85	44	—	—	—	—
N135	56'3" x 28'4" x 12'	1,585	80	—	152	78	—	—	—	—
N136	58'5" x 29'11" x 12'	1,734	80	—	180	87	—	—	—	—
N137	58'5" x 28'4" x 11'11"	1,651	80	—	167	81	—	—	—	—
N138	58'5" x 28'4" x 10'	1,652	80	—	169	81	—	—	—	—
N139*	58'6" x 29'9" x 12'	1,729	80	—	169	87	—	—	—	—
N140*	58'6" x 29'9" x 12'	1,708	80	—	162	86	—	—	—	—

Convention Center North Building— Level Two

N226	58' x 58'9" x 13'11"	3,409	160	—	286	168	—	—	—	—
N227	130'10" x 45'10" x 15'11"	5,998	352	—	589	297	—	—	—	—
N227A	41' x 45'10" x 15'11"	1,874	72	—	144	81	—	—	—	—
N227B	89'11" x 45'10" x 15'11"	4,124	224	—	420	206	—	—	—	—
N228	89'6" x 58'5" x 15'11"	5,205	280	—	494	258	—	—	—	—
N229	58'5" x 58'3" x 13'11"	3,366	152	—	270	165	—	—	—	—
N230	108'3" x 45'9" x 15'10"	5,010	272	—	455	249	—	—	—	—
N230A	45'9" x 39'7" x 15'10"	1,840	72	—	144	84	—	—	—	—
N230B	66'11" x 45' x 15'10"	3,170	144	—	300	156	—	—	—	—
N231	58' x 58' x 13'11"	3,384	152	—	250	169	—	—	—	—

Convention Center North Building— Level Four

N426	120'6" x 58'10" / 54'10" x 17'6"	7,037	374	—	634	312	—	—	—	—
N426A	39'5" x 59'10" x 17'6"	2,295	122	—	204	102	—	—	—	—
N426B	42' x 59'10" x 17'6"	2,438	130	—	216	108	—	—	—	—
N426C	39'5" x 59'10" x 17'6"	2,300	122	—	204	102	—	—	—	—
N427	129'10" x 58'10" / 54'10" x 17'6"	7,539	400	—	666	333	—	—	—	—
N427A	32'4" x 58'10" x 17'6"	1,887	100	—	166	83	—	—	—	—
N427BC	64'10" x 58'10" x 17'6"	3,768	200	—	304	167	—	—	—	—
N427D	32'4" x 58'10" x 17'6"	1,882	100	—	166	83	—	—	—	—

CAPACITY CHART



Room Name	Room Dimensions L x W x H	Room Size Sq. Ft.	Banquet	Reception	Theater	Classroom	Boardroom	U-Shape	Hollow Square	Exhibit
-----------	------------------------------	----------------------	---------	-----------	---------	-----------	-----------	---------	------------------	---------

Lakeside Center— Level Two

E253	121'4" x 53'5" x 13'11"	6,677	384	—	744	333	—	—	—	—
E253A	31'3" x 53'6" x 13'11"	1,840	80	—	189	90	—	—	—	—
E253B	30'2" x 53'6" x 13'11"	1,612	64	—	173	78	—	—	—	—
E253C	30'1" x 53'5" x 13'11"	1,612	64	—	173	78	—	—	—	—
E253D	29'11" x 53'5" x 13'11"	1,613	64	—	173	78	—	—	—	—
E254	60'5" x 22'8" x 8'4"	1,190	SHOW OFFICE FURNITURE							
E255*	57'9" x 25' x 14'1"	1,439	56	—	153	72	—	—	—	—
E256*	57'8" x 24'11" x 14'1"	1,445	56	—	153	72	—	—	—	—
E257	49'5" x 22'6" x 12'	1,214	40	—	50	48	—	—	—	—
E258	55'11" x 48'3" x 11'11"	2,718	128	—	252	135	—	—	—	—
E259	51'9" x 25'11" x 12'	1,353	64	—	138	60	—	—	—	—
E260	39'5" x 26' x 12'	1,034	40	—	102	51	—	—	—	—
E261	39'5" x 26' x 12'	1,032	—	102	51	—	—	—	—	—
E262	39'5" x 26' x 12'	1,039	40	—	102	51	—	—	—	—
E263	39'5" x 26' x 12'1"	1,023	40	—	102	51	—	—	—	—
E264	39'3" x 26' x 11'10"	1,032	40	—	102	51	—	—	—	—
E265	56' x 48'4" x 12'	2,723	128	—	252	135	—	—	—	—
E266	43'8" x 25'5" x 12'	1,123	48	—	50	48	—	—	—	—
E267	43'8" x 26' x 11'11"	1,096	56	—	102	54	—	—	—	—
E268*	56'5" x 33' x 8'14"	1,840	72	—	181	90	—	—	—	—
E269*	68'2" x 35'6" x 8'11"	2,354	112	—	228	117	—	—	—	—
E270	74'3" x 36'9" x 12'1"	2,736	120	—	275	135	—	—	—	—
E271	104' x 56'11" x 12'	5,812	312	—	623	288	—	—	—	—
E271A	61'4" x 53'6" x 12'	3,422	160	—	360	168	—	—	—	—
E271B	42'8" x 55'10" x 12'	2,380	152	—	234	108	—	—	—	—
E272A	31'9" x 12'10" x 9'	412	24	—	41	18	—	—	—	—
E272B	31'10" x 11'10" x 9'	387	24	—	34	18	—	—	—	—
E272C	31'8" x 12' x 9'	382	24	—	34	18	—	—	—	—
E272D	31'8" x 15'2" x 9'	468	24	—	40	21	—	—	—	—

Lakeside Center— Level Three

E350	88'1" x 56'2" x 11'	4,900	—	—	345	FIXED SEATING	—	—	—	—
E351	88'1" x 56'2" x 11'	4,901	—	—	345	FIXED SEATING	—	—	—	—
E352	88'1" x 56'2" x 11'	4,913	—	—	345	FIXED SEATING	—	—	—	—
E353	153'7" x 83'6" x 15'11"	12,904	696	—	1,346	642	—	—	—	—
E353A	80'2" x 37'6" x 15'11"	3,170	144	—	248	156	—	—	—	—
E353B	83'7" x 56' x 15'11"	4,677	240	—	400	234	—	—	—	—
E353C	83'6" x 60'1" x 15'11"	5,041	256	—	400	249	—	—	—	—
E354	304'5" x 191'2" x 48'	44,754	2,382	—	4,010	1,986	—	—	—	—
E354A	152'3" x 191'2" x 48'	22,377	1,190	—	2,005	983	—	—	—	—
E354B	152'3" x 191'2" x 48'	22,377	1,190	—	2,005	993	—	—	—	—

Lakeside Center— Level Four

E450	177'2" x 85'7" x 20'6"	14,550	968	—	1,500	726	—	—	—	—
E450A	88'7" x 82'6" x 20'6"	7,212	432	—	600	360	—	—	—	—
E450B	89'1" x 85'7" x 20'6"	7,338	440	—	740	366	—	—	—	—
E451	144' x 84' x 20'4"	12,115	672	—	1,314	603	—	—	—	—
E451A	84' x 62'2" x 20'4"	5,228	288	—	504	261	—	—	—	—
E451B	81'10" x 84'7" x 20'4"	6,884	392	—	634	342	—	—	—	—